

Vistafold 120S



Fitting Guidelines

Revised 18th April 2017



System Specifications;

Maximum Leaf Width: 1000mm
Maximum Leaf Height: 3300mm

Door Thickness: 44mm minimum
Maximum Leaf Weight: 120kg

Materials used are Stainless Steel 316 for the hinge pins and 304 stainless for the remainder.

Main Points to consider

Vistafold 120S is currently only suitable for odd leaf configurations upto 7 leaves.

Alternatively you can use a sliding post to create an even leaf layout.

Vistafold 120S's major feature is that it can be made to fit into a standard door or window frame detail. As all tracks are inline this dramatically aids with both cost of manufacture and in the aesthetics of the installation - especially when in close proximity of standard doors or windows.

Vistafold 120S utilises Face Fix Hinges which have 4mm thick flaps.

1mm thick Shim's are available should you wish to add an element of adjustability to the width of the system.

If you are using shims on all hinge points then allow 6mm along frame verticals and between leaves, 5mm along frame head and either 5mm at bottom seal.

If you choose not to use shim's then allow 4mm along frame verticals and between leaves, 5mm along frame head and either 5mm at bottom seal.

Aquamac 21 seals are recommended both around the frame and between door panels. Allow 5-6mm between rebates on frame and internal door face.

The bottom Roller has a height adjustment of +/- 3mm and is factory set in the lowest position. This can be adjusted by unscrewing the grub screw on the rear (internal) side of the roller block. You can then close the doors and adjust the height using the 4 sided nut on the bottom of the roller block hinge knuckle . Once adjusted simply open the doors and re-tighten the grub screw to lock in position.

Cutout Requirements

The cutouts for both the top guide plate and the bottom roller are the same **apart** from the height.

For the top guide the cutout is 8mm high whereas the bottom roller cutout is 35mm high.

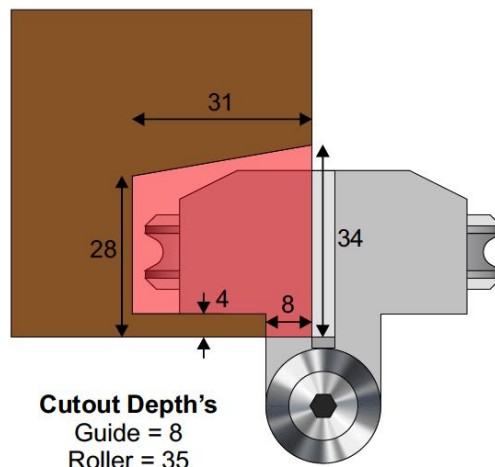

We recommend that a weather bar be added to the bottom edge of the doors to aid the minimisation of water ingress to the track area.

Router bits are available for the flush bolts to ensure accurate cutouts and perfect finish.

If you plan to set up a machine to make the required cutouts please let us know and we will arrange CAD drawings to aid with this.

Track & Guide Channel Details

Track & Channel Centrelines = 15mm from face of door on the Bottom Roller cut out side.

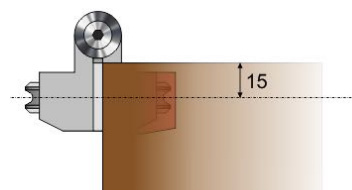

Surface Mount Track 814a = 21mm wide x 8mm high



Recessed Mount Track 815a = 25mm wide x 8mm high



Top Guide Channel 191a = 21mm wide x 21mm high

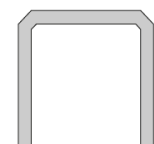

Please note track and channel only needs to extend 10mm past last roller block when in the closed position as no track is required underneath or above swing leaves. Also if using recessed track drainage holes will be needed through track and out through underside of cill.

Hardware Layout

The Diagrams on the following pages show where the hardware is located on the doors and the 2 options for the bottom track.

Flush bolts are usually located on the odd leaves (apart from those with handles and lock) and ensure that the hinge line that breaks out of the frame when folding is securely held against rebate when doors are closed.

A Holdback catch is available and is usually mounted between swing leaf and adjoining leaf. When doors are operated the swing leaf must be securely held by a holdback catch to safely fold the doors in either direction.

We also supply Hinge Pins which are to be mounted between top/middle and middle/bottom hinges where the knuckle is external. This prevents any tampering with the hinges resulting in forced access as the hinge pins will keep the doors in line and secure.

Locking Options

We can offer 2 locking alternatives;

Option 1 - A PAS24:2012 Multipoint locking system complete with high security lock cylinder

Option 2 - Hybrid Lock & Keep set incorporating a hook throw with a standard cylinder.

Door Handles in Satin Stainless Steel finish are also available.

Flush Bolts are available in both locking and non locking variants. For maximum security we would suggest both top and bottom bolts are of the locking variety. However you can choose to have one of each type or even both non locking bolts if your application is not security conscious - such as internal applications.

For advise on any of the locking options please call on 01708 891515.

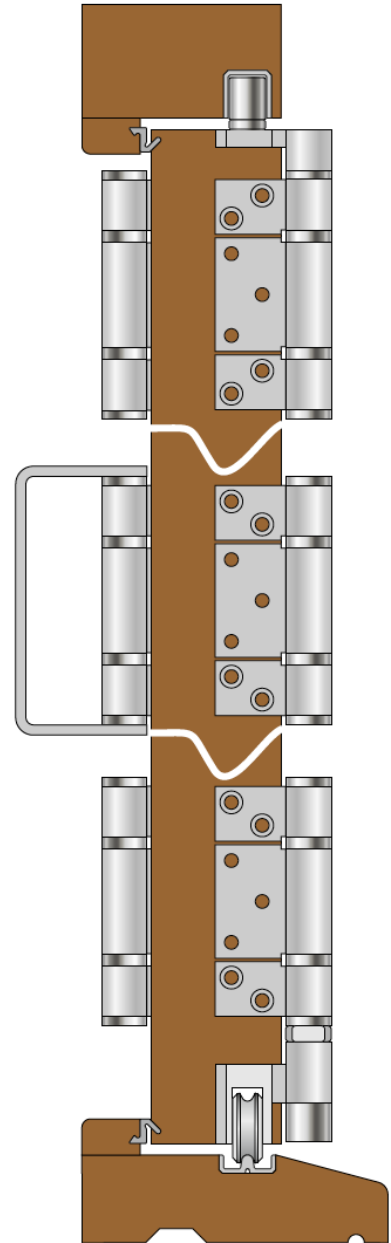

Alternative bottom cill options

When using the surface mount track you can surface fix the track without any rebate detail. You can even mount on the declining slope if preferred as the tracks running surface will allow a slight angle upto around 10 degrees.

If you have an instance where a flat threshold is required the 815a recessed track can be mounted flush into a floor. For weather resistance this is not ideal, however with a gentle fall in the floor away from the doors, a weather bar on the bottom of the doors along with brush strip on the undersides, wind and water penetration can be minimised or even eradicated.

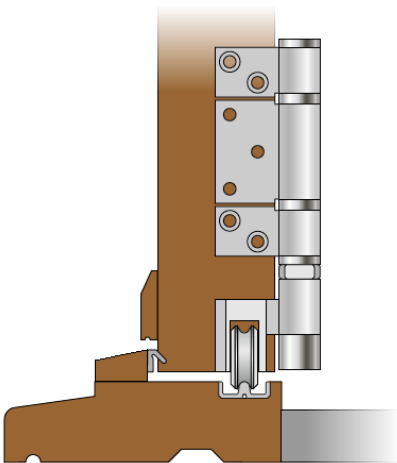
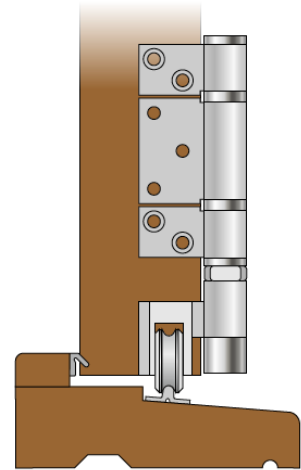

Internally folding doors can easily be achieved by altering the bottom cill and frame so that the rebate is on the external side. Addition of a weather bar along with a slight gradient on the top of the external rebate descending away from the door face will deter sitting water on the surface. It would also be prudent to have drainage holes through cill between rebate and channel to aid water agree should any make their way through.

PAS 24:2016

Vistafold 120S is an extremely robust system and we are committed to it passing PAS24:2016 accreditation. This test is currently being planned and results will be posted once complete.

Once Vistafold 120S has passed PAS24:2016 we will be able to advise on door construction, type of timber and provide all required hardware to ensure Part Q requirements are met on site.

For any further details on Vistafold 120S please call our sales office on 01708 891515 or email enquiries to sales@barrier-components.co.uk

