

BI-FOLDING HD KIT

Galvanised accessories Kit with aluminum hinges for Bi-folding Heavy Duty system. The new HD system has all the classical Bi-folding features, with a reinforced arm which permits to sustain heavier leaves. All the hinges, specifically designed, guarantee a quick but very precise movement, without the need of any ground rail, giving as result a system of exceptional solidity. In addition, the folding leaves allow to reduce the footprint to the minimum during the opening and closing phase. Our Bi-folding HD is designed for both industrial and commercial use, with a particular attention to the protection and security needs.

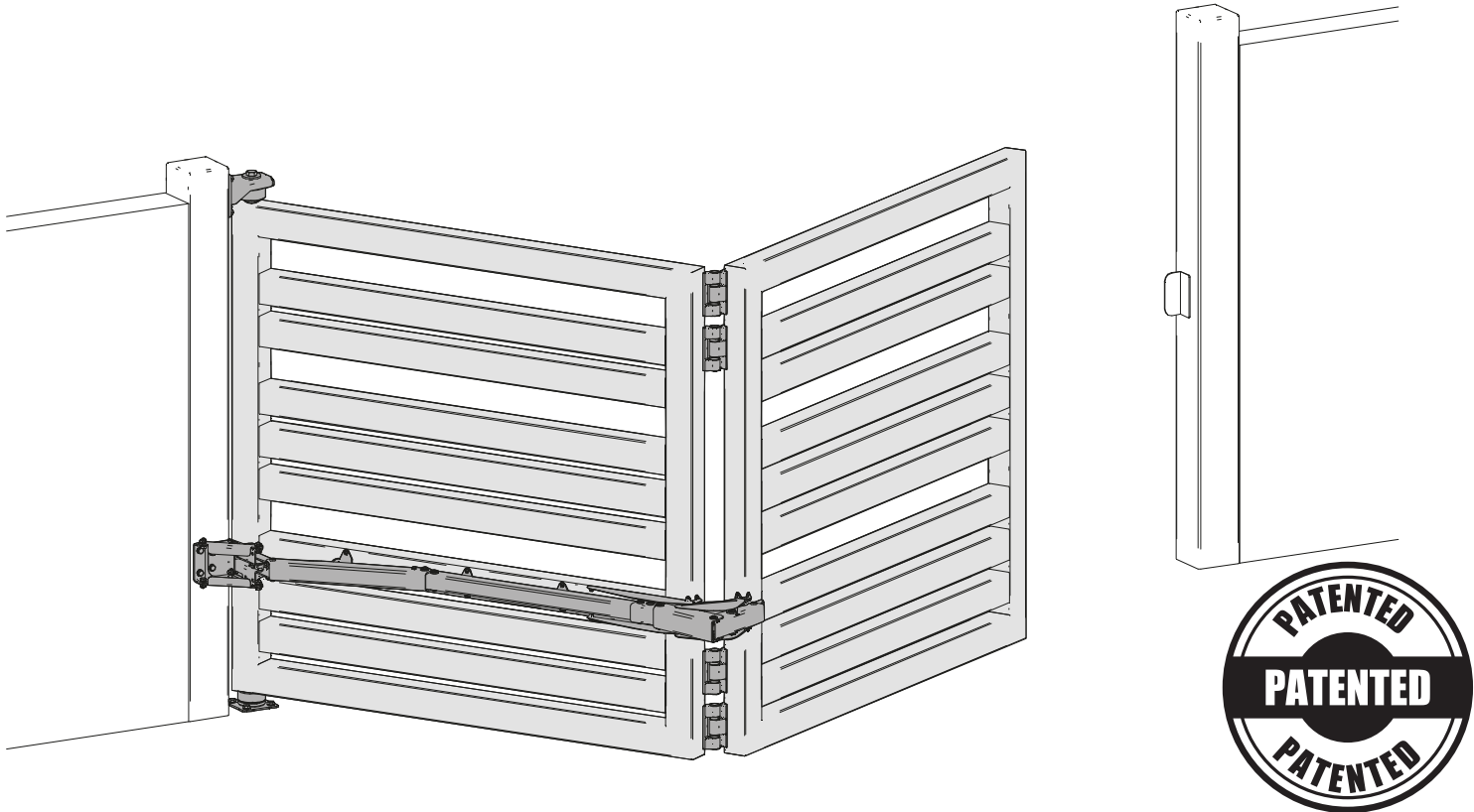

1 kit
for single gate

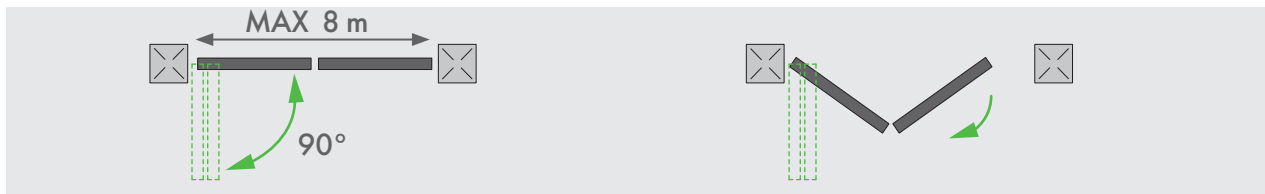

2 kit
for double gate

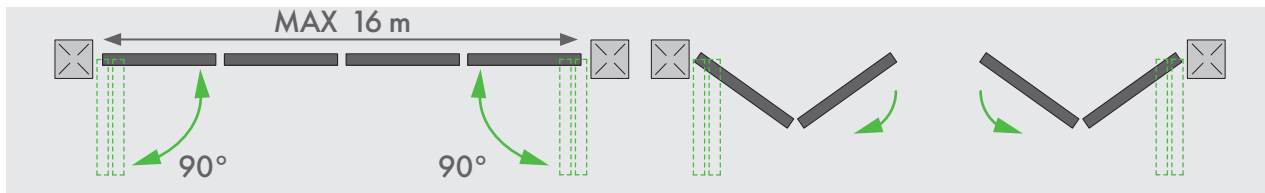

KC7110.180 WITH ROUND HINGE TO WELD



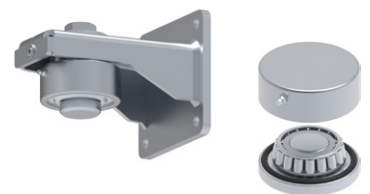

VC4114.090 Round upper Hinge

VC4202.090 Round bottom Hinge



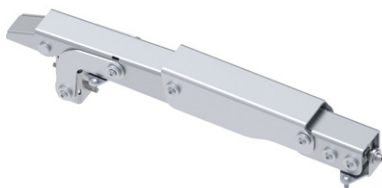

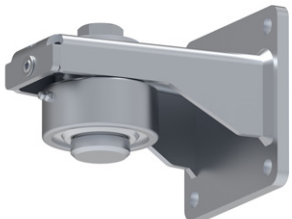
COMPONENTS

<p>x1</p> 	<p>x1</p> 	<p>x4</p> 	
<p>VC7101.080</p>	<p>VC7102.080</p>	<p>VL4500.140.V</p>	
<p>x2</p> 	<p>x1</p> 	<p>x1</p>  <p>PLATE INCLUDED</p>	<p>x1</p> 
<p>VC7105</p>	<p>VC4114.090</p>	<p>VC4202.090</p>	<p>Drilling Template</p>



GUIDE PROFILE

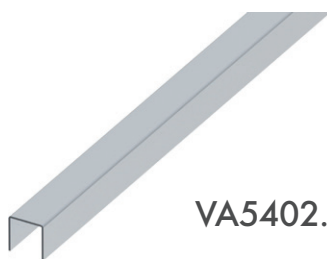

VA5402.003

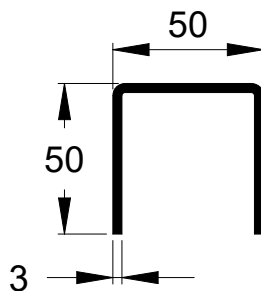

Materials
S235JR-Fe360.B



RELATED ARTICLES

Click on our website for other related items



VC9101
VC9111



VC5101
VC5102
VC5103

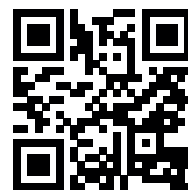

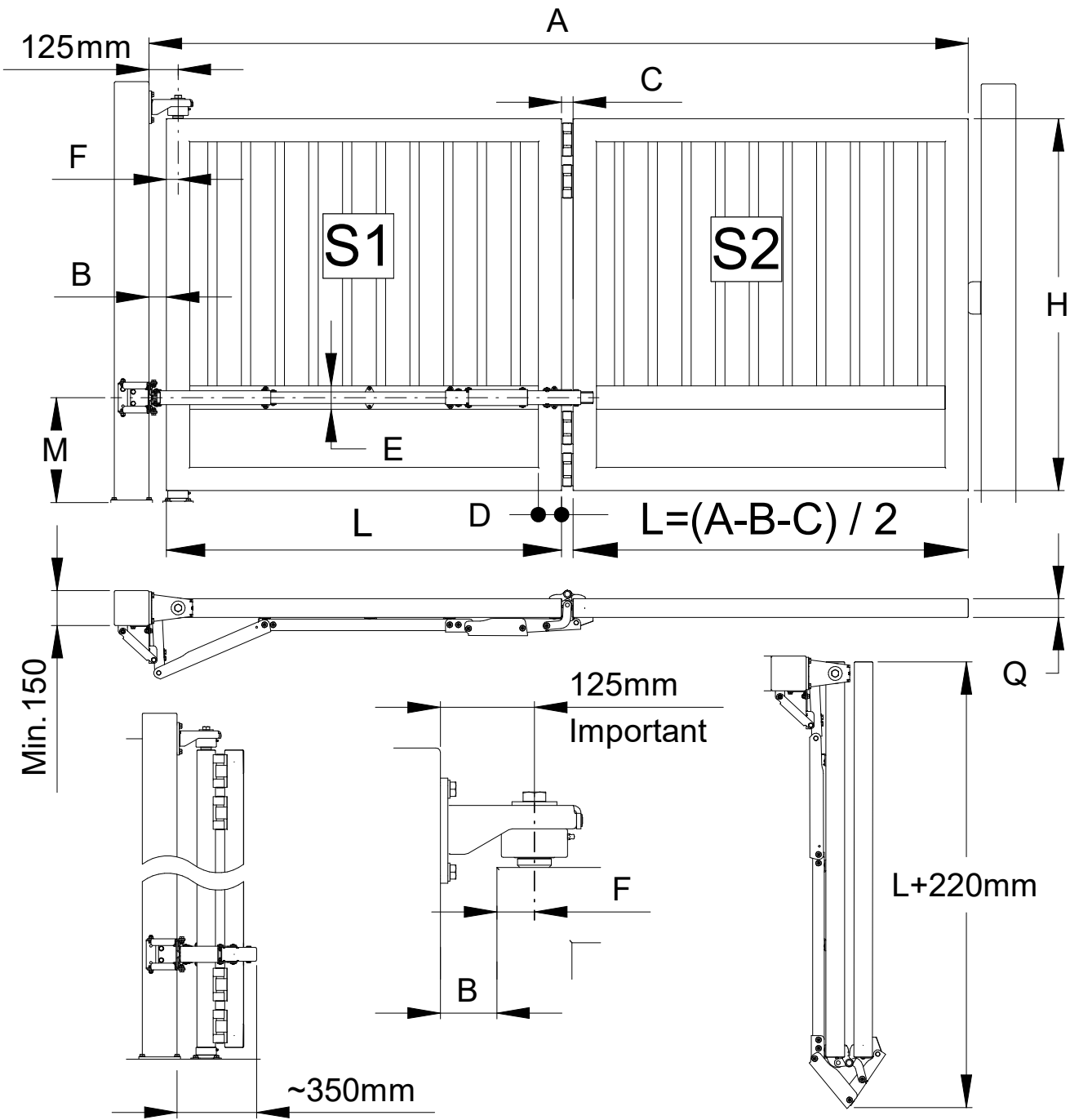

SIZES CHART

A min-max (m)	B min (mm)	C (mm)	D min (mm)	E min (mm)	M	L min (m)	Q (mm)	A/H max
3 - 8	75	50	50	100	Near the engine	1,44	50-60-80	3

OPENING A (m)	L (m) with B=0,07 m	max S2 (kg)
3	~ 1,43	525
4	~ 1,93	380
5	~ 2,43	300
6	~ 2,93	250
7	~ 3,43	220
8	~ 3,93	180

EXAMPLE OF OUT-OF-TABLE MEASUREMENTS

A = 5,6 m
 B = 85 mm
 C = 50 mm (as per above table)
 $L = (A - B - C) / 2$
 $L = (5,6 - 0,085 - 0,05) / 2$
 $L = 5,465 / 2$
 $L = 2,73$ m

MAX WEIGHT S2 IN RELATION TO L

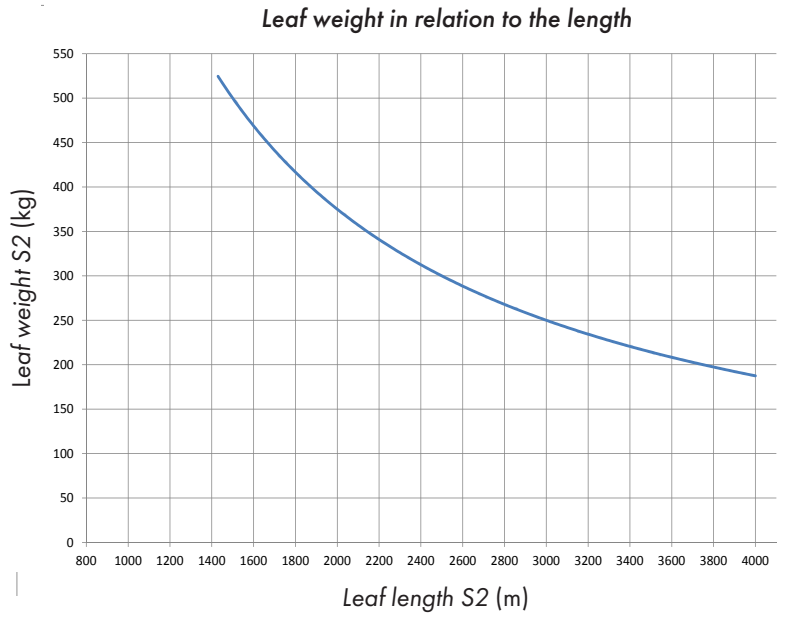
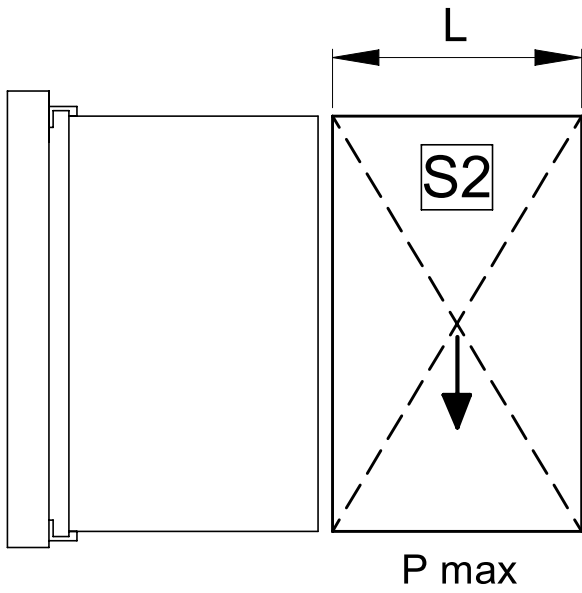

HINGES WEIGHT CAPACITY IN RELATION TO A/H

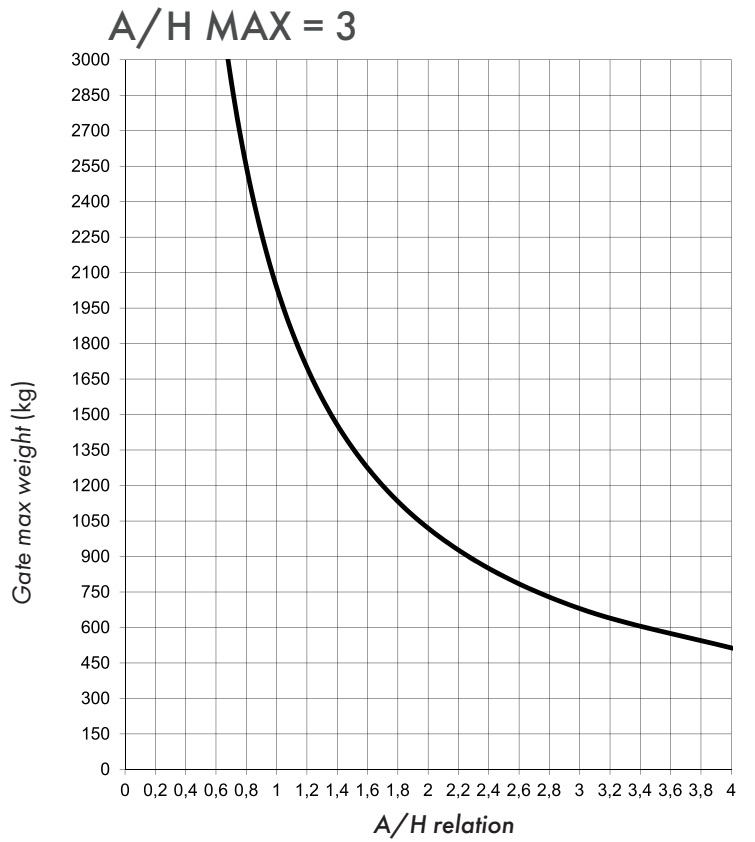
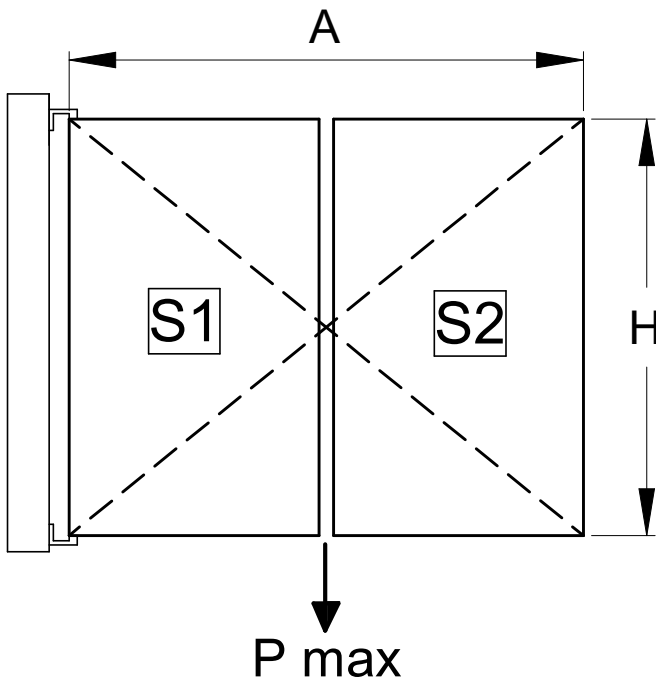

The crossing point between weight and A/H relation must be under the curve of the chosen kit.



FOLLOW THE STEPS ILLUSTRATED IN THE IMAGE BELOW TO CORRECTLY ASSEMBLE THE COLUMN JOINT.

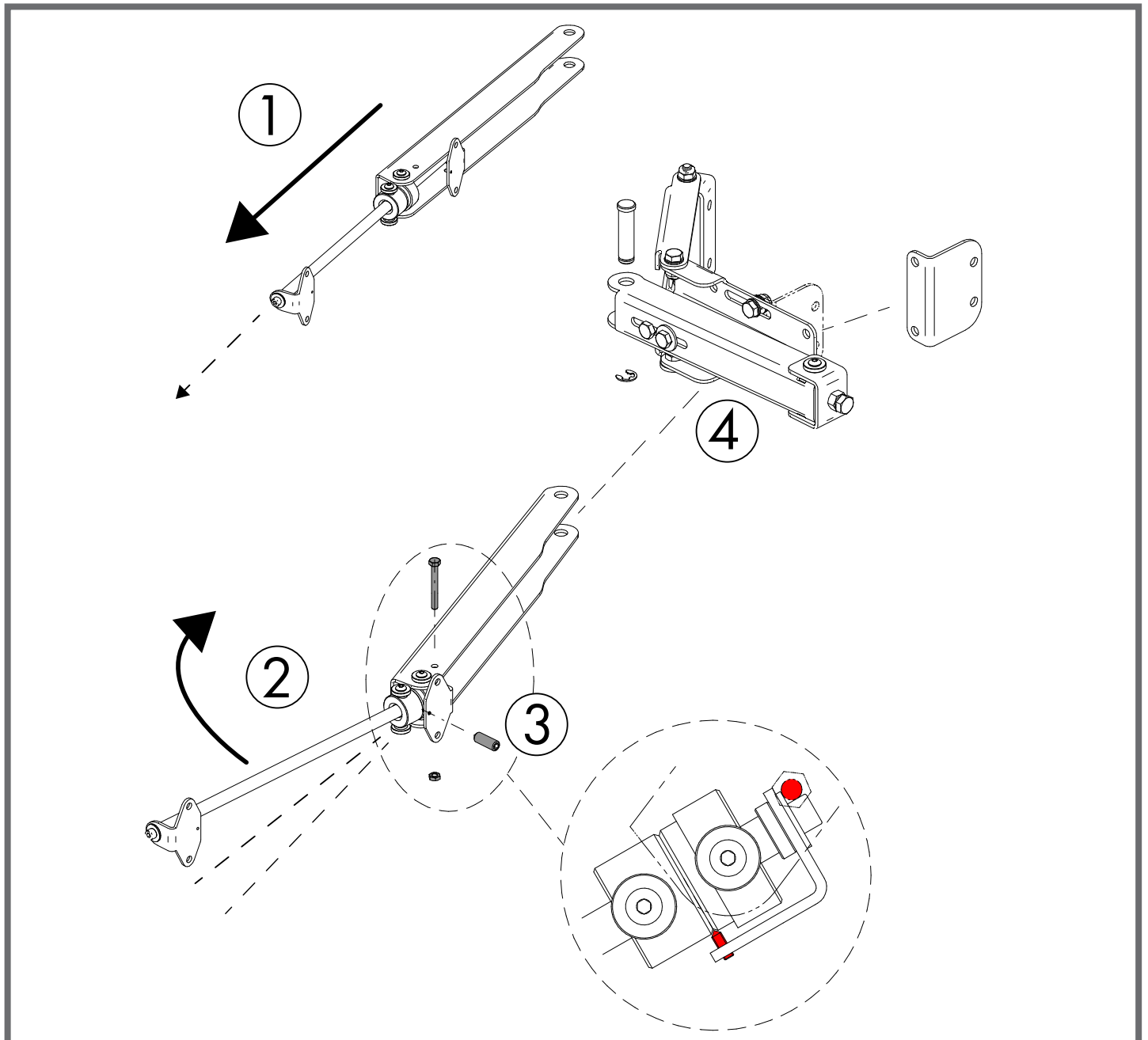



TECHNICAL INFO

1. For motorised gates provide slow starting points, soft stops and suitable speed in order to avoid elastic effects between the leaves. Accelerations, decelerations and high-speed variations can shorten the system duration and can cause malfunctions and disruptions.

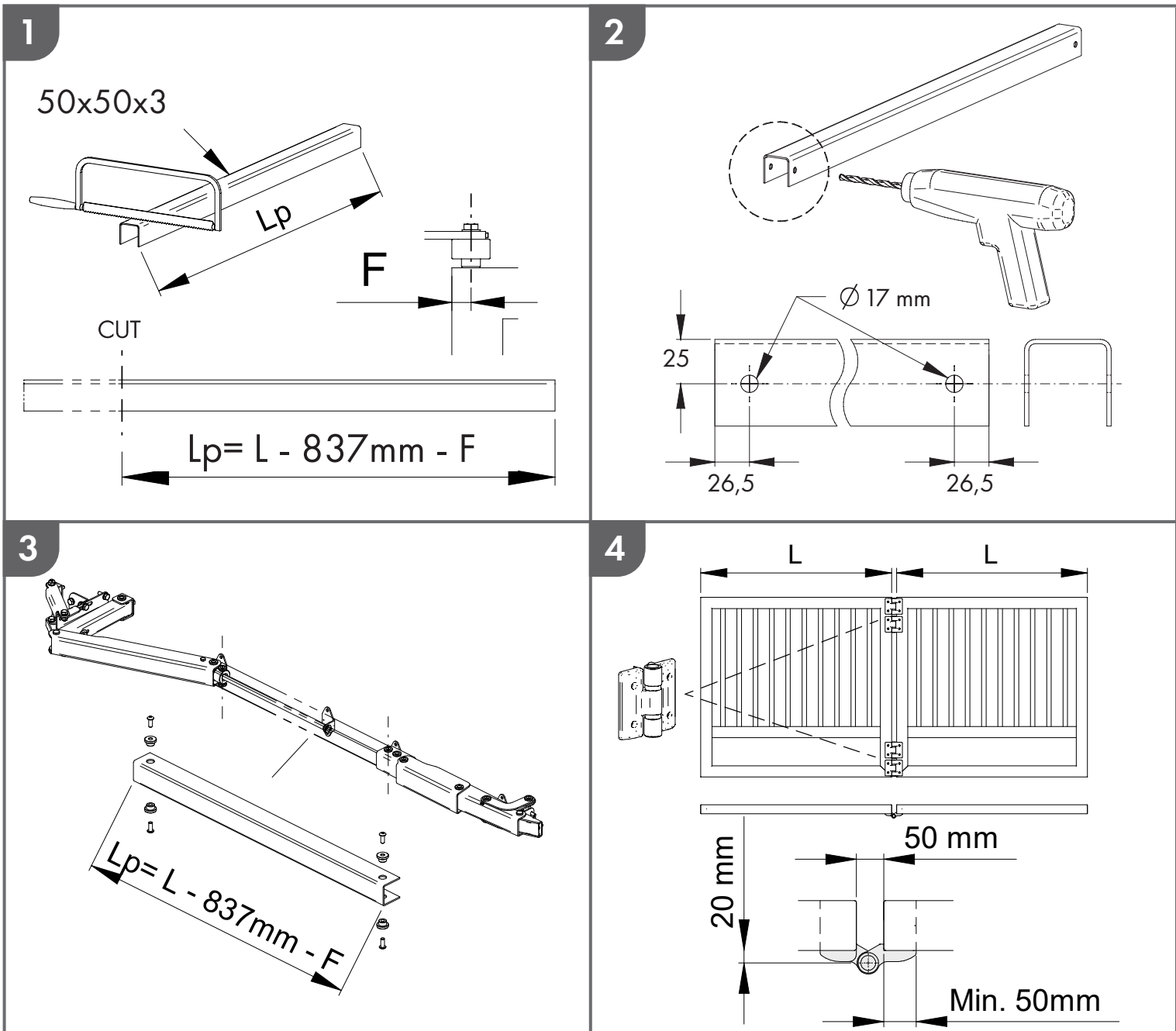

5

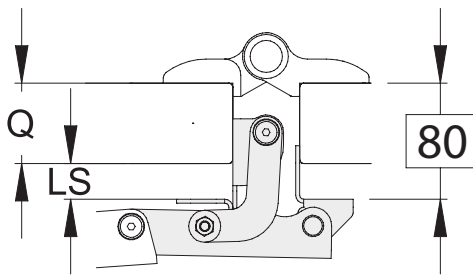

Q (mm)	LS (mm)
50	30
60	20
80	/

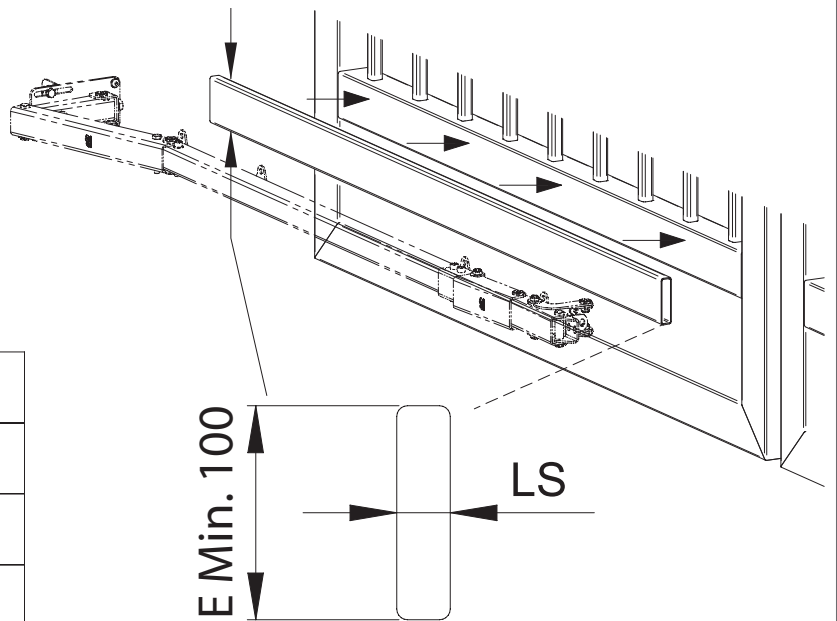

6

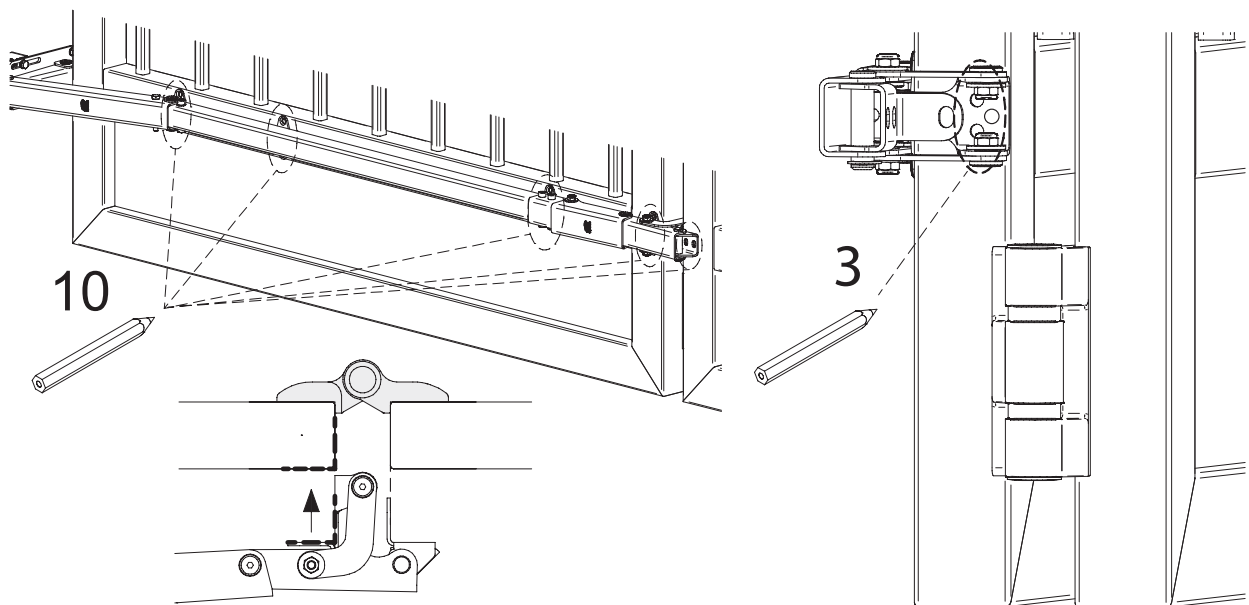

7

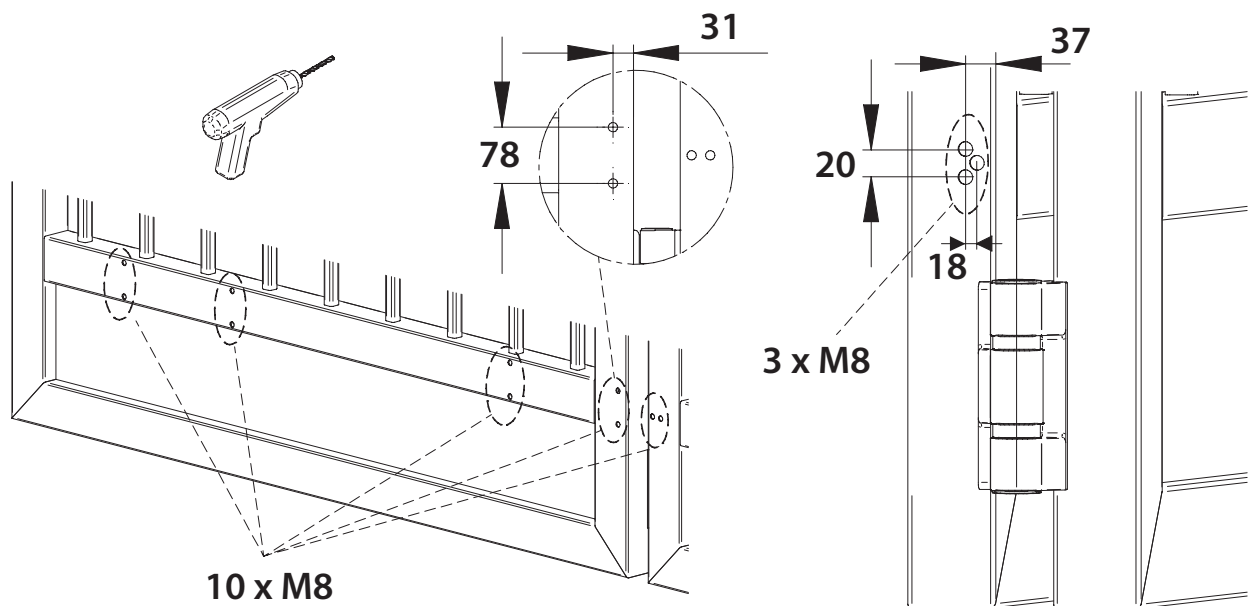



8

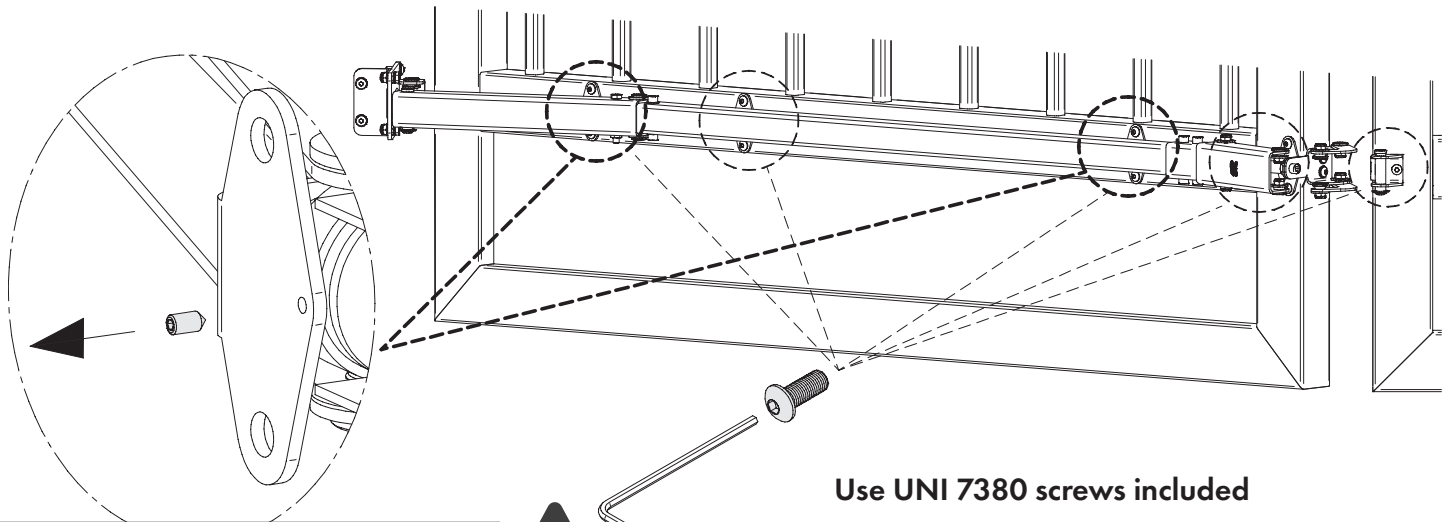

Use UNI 7380 screws included

Remove before fixing



Fix front screws only

9

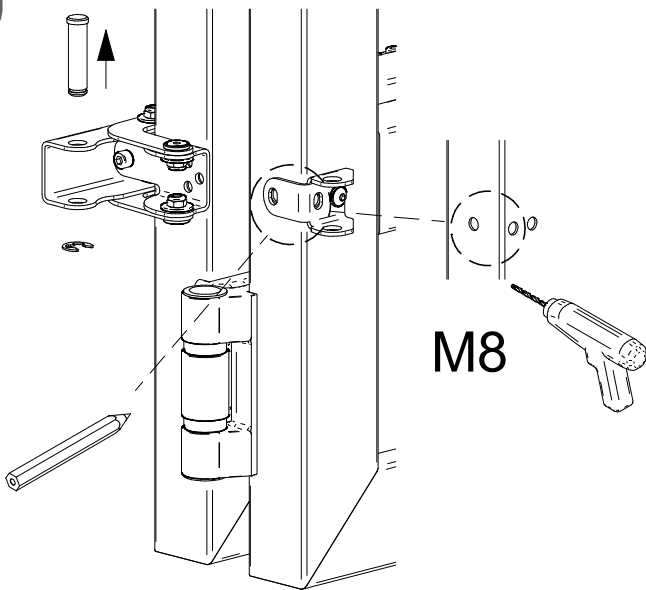

M8

10

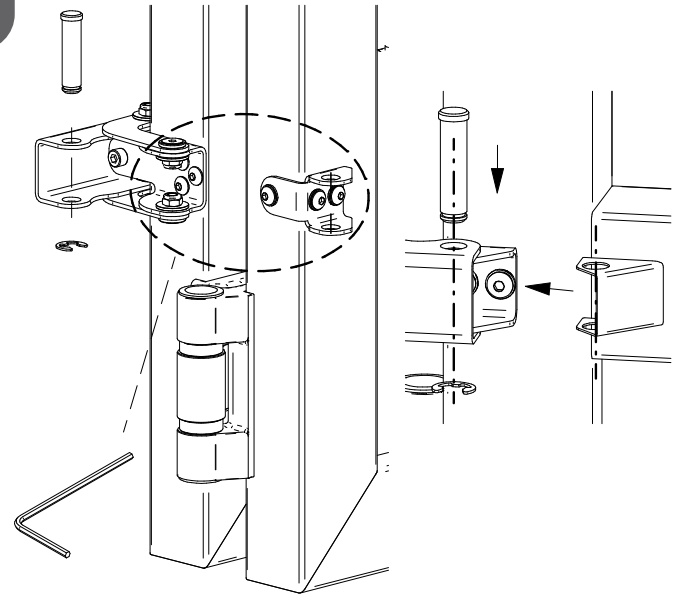

11

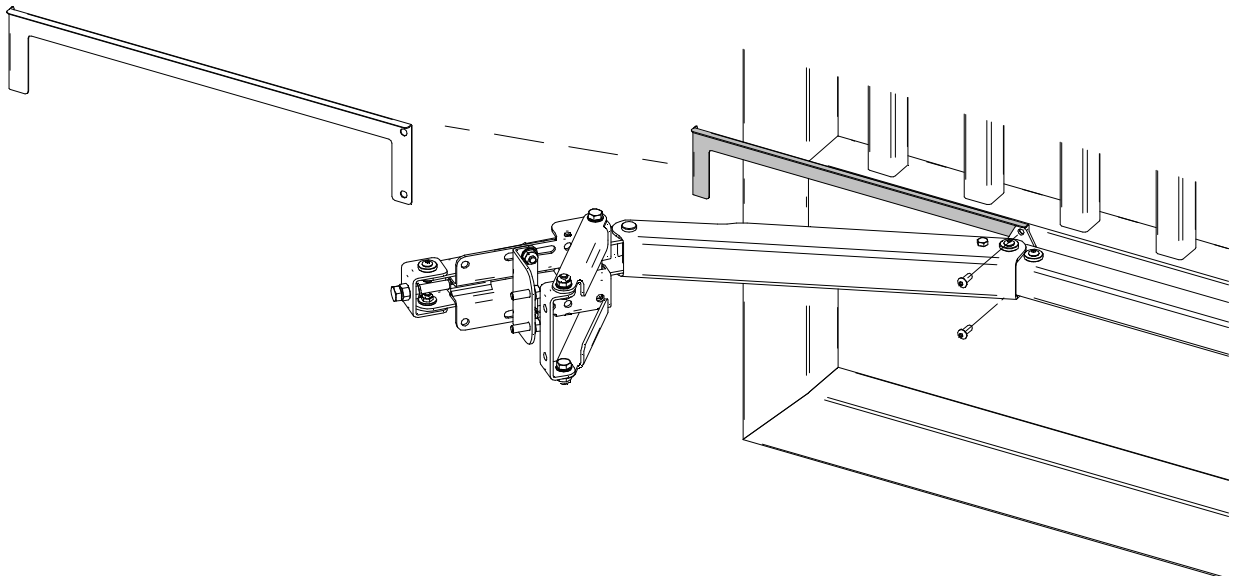

12

125

Mark the holes with the gate in closed position

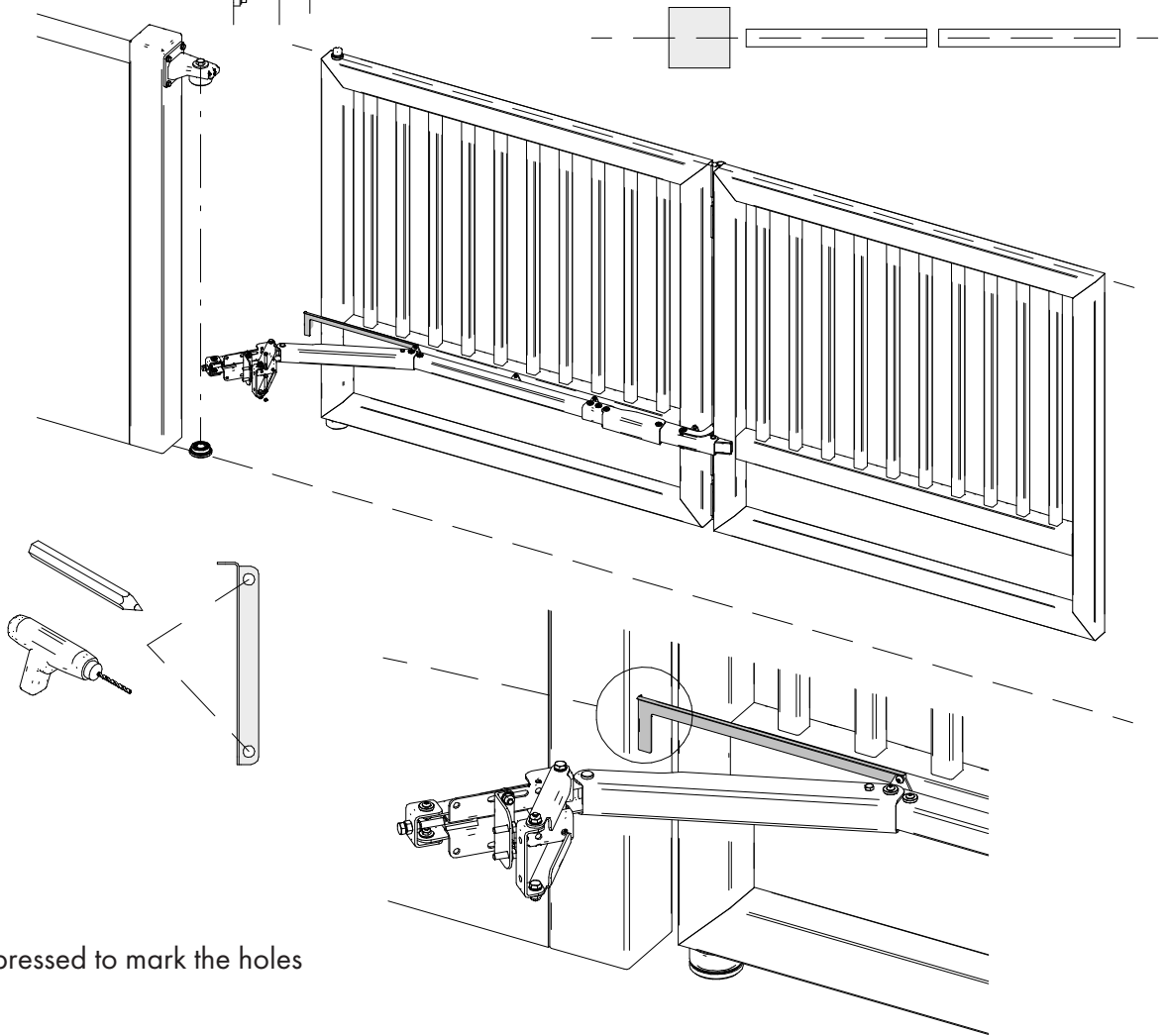

Keep pressed to mark the holes

13

Remove

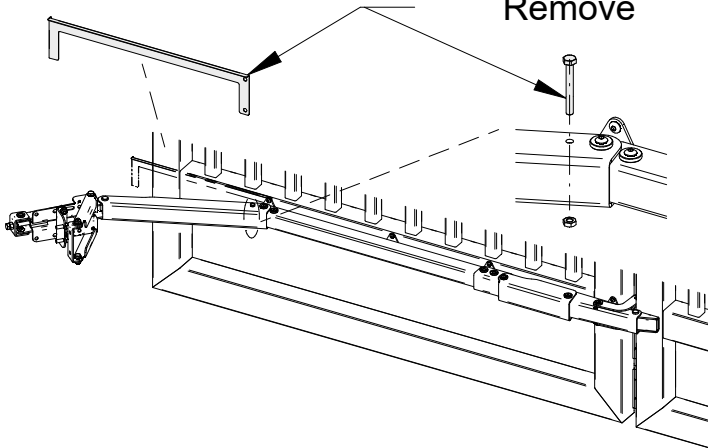

14

Fix

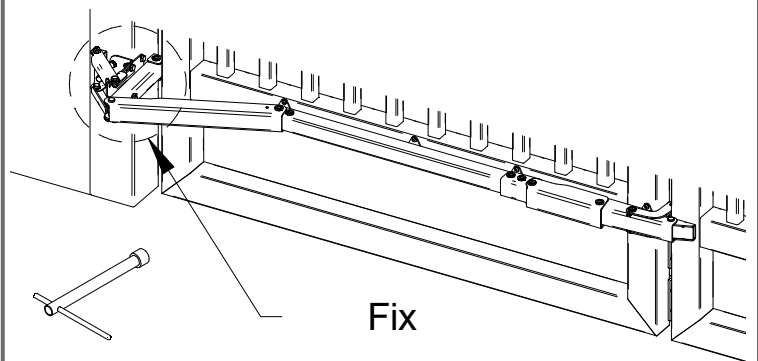

15

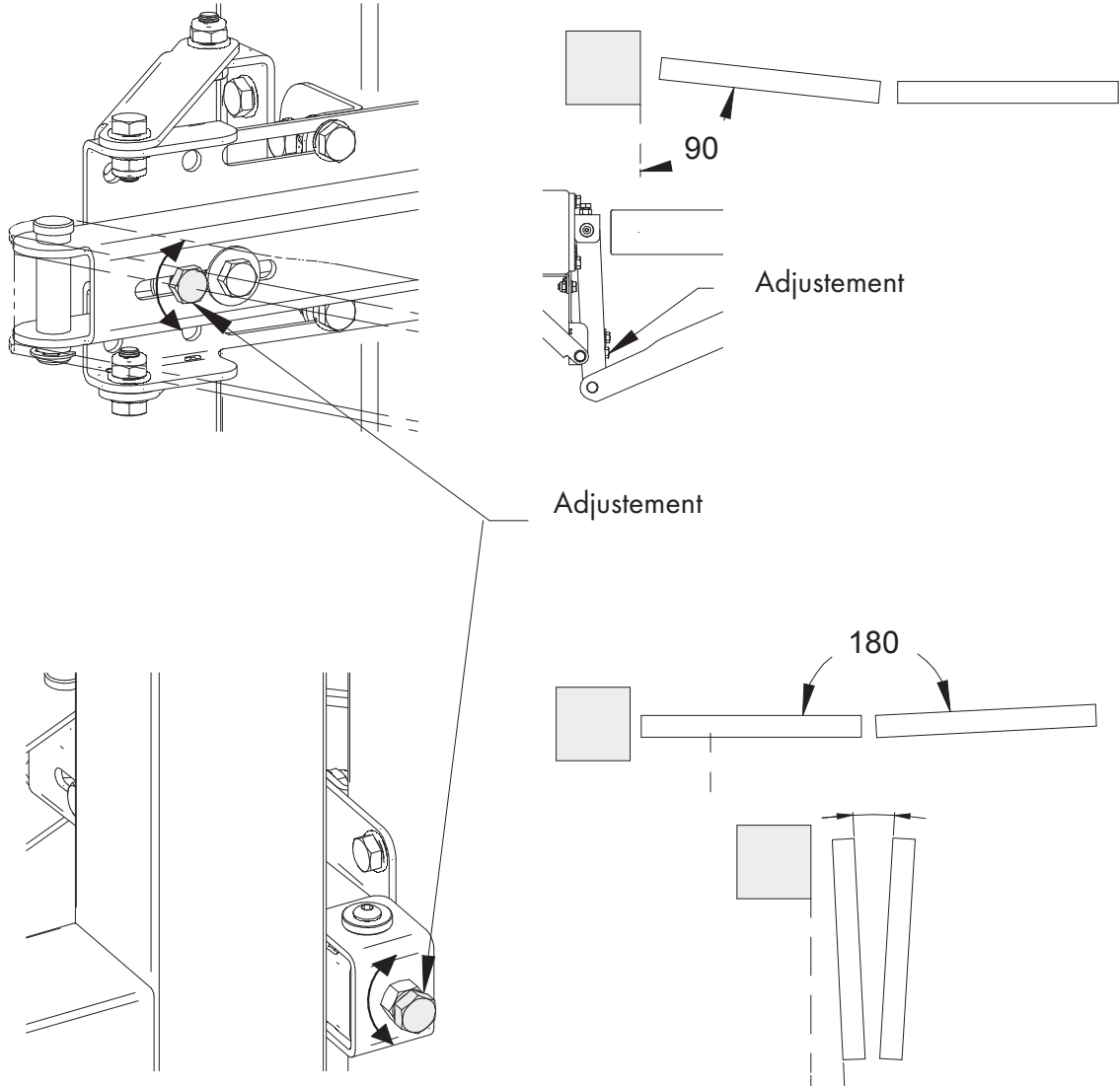

16

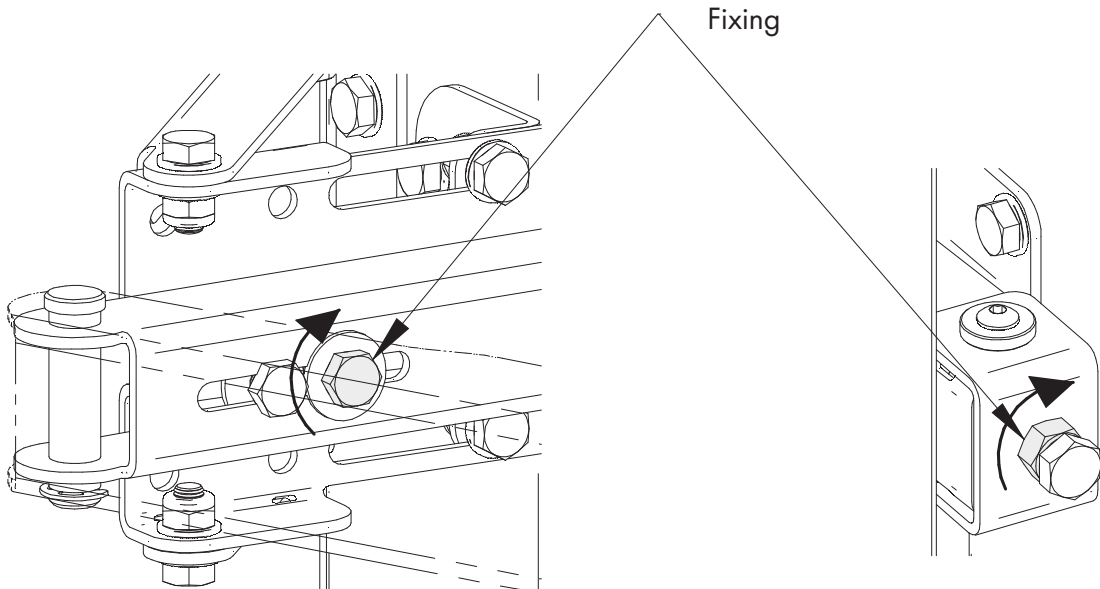

17

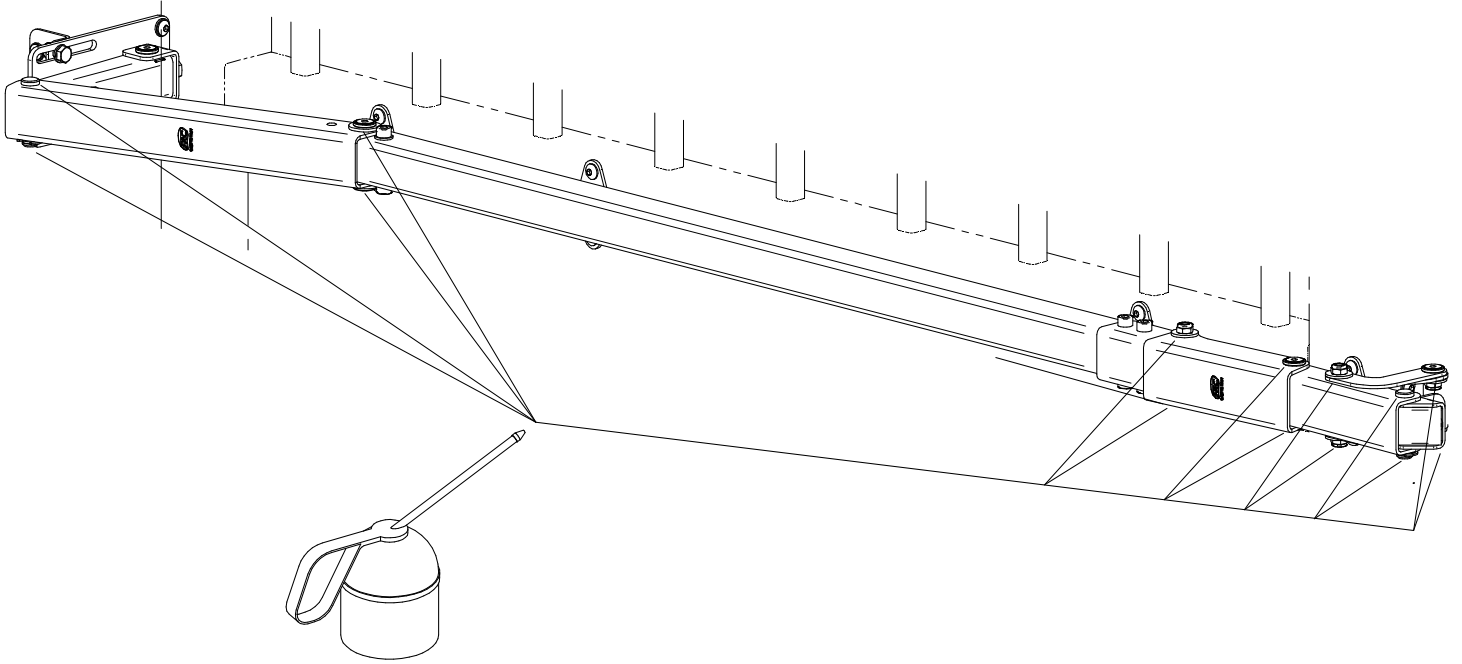

18

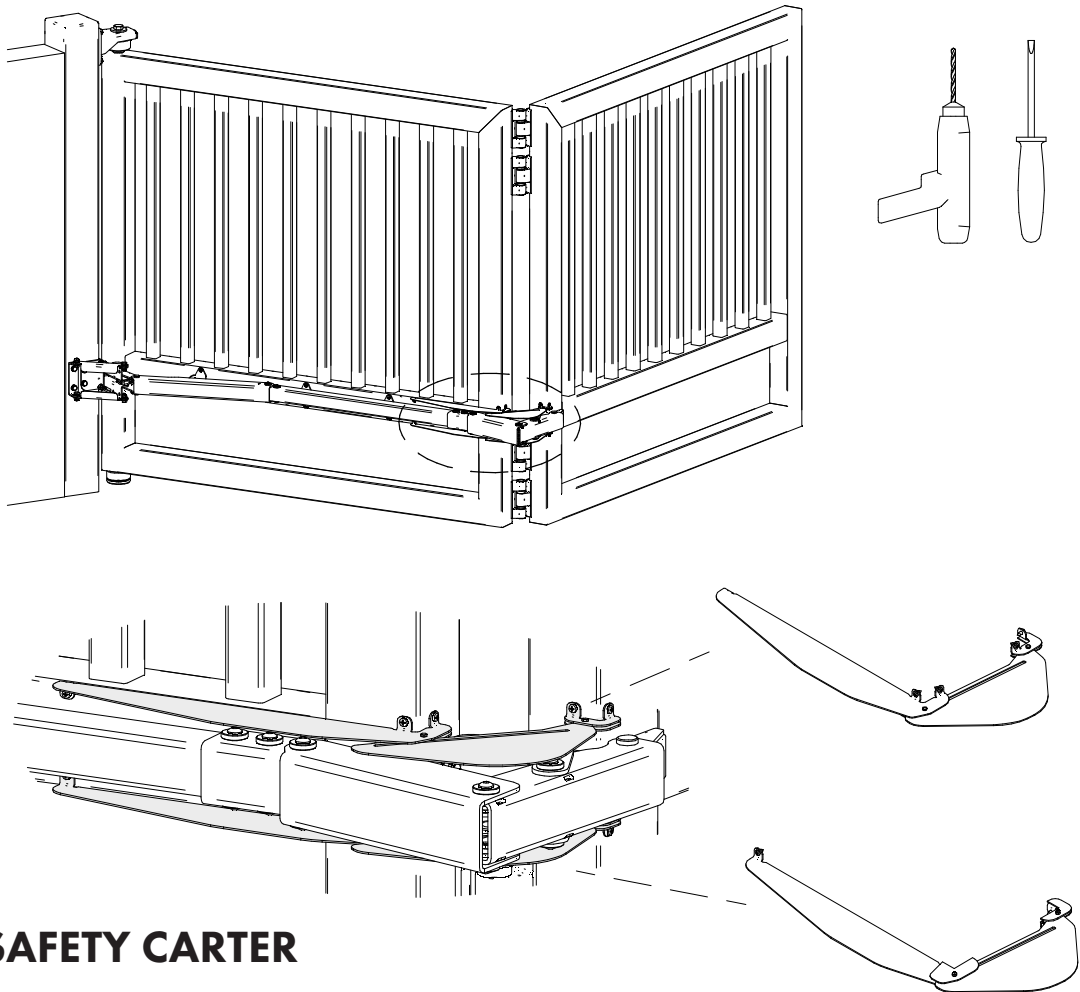

SAFETY CARTER



MAINTENANCE

1. Perform all functioning inspections manually at the end of the installation; periodically check that the system is functioning, that it is well lubricated and does not have any loosening (we suggest a full examination every 3 months or maximum 20.000 cycles).
2. In case of malfunctions due to wear or accidental impacts, make sure that all components apt to support the gate and its movement are intact. If necessary, proceed with substitution.
3. FAC ensures the system correct functioning only using original spare parts.

Attention: The kit included accessories and the proposed installation make reference to a standard example. An installation not in accordance with the illustrated procedure and the omission of the correct maintenance might compromise nearby things and people's security. Make sure that all accessories suit the specific work and make sure to use the necessary safety devices provided by current regulations.

For more information: info@facsrl.com